

Mimitakara[®]



Mimitakara UP-6ER7

Digital Hearing Aid

User Guide

| | |
|--|----|
| Welcome | 1 |
| Your hearing instruments | 2 |
| Instrument type | 2 |
| Getting to know your hearing instruments | 2 |
| Components and names | 2 |
| Batteries | 4 |
| Battery size and handling tips | 4 |
| Replacing batteries | 5 |
| Daily use | 6 |
| Turning on and off | 6 |
| Inserting and removing the hearing instruments | 6 |
| Adjusting the volume | 9 |
| Maintenance and care | 10 |
| Hearing instruments | 10 |
| Ear pieces and tubes | 11 |
| Professional maintenance | 13 |
| Further information | 14 |
| Safety information | 14 |
| Troubleshooting | 15 |
| Safety manual | 16 |

Welcome

Thank you for choosing our hearing instruments to accompany you through everyday life. Like anything new, it may take you a little time to become familiar with them.

This guide, along with support from your Hearing Care Professional, will help you understand the advantages and greater quality of life your hearing instruments offer. To receive the most benefit from your hearing instruments, it is recommended that you wear them every day, all day. This will help you get adjusted to them.



CAUTION

It is important to read this user guide and the safety manual thoroughly and completely. Follow the safety information to avoid damage or injury.

Your hearing instruments

Instrument type

Your hearing instruments are BTE (Behind-The-Ear) models. A tube delivers the sound from the hearing instrument into the ear.

The instruments are not intended for children under the age of 3 years or persons with a developmental age of under 3 years.

Your hearing instruments have pre-configured sound profiles. Your Hearing Care Professional has set the appropriate sound profile for you.

Getting to know your hearing instruments

It is recommended to familiarize yourself with your new hearing instruments. With the instruments in your hand try using the controls and note their location on the instrument.

This will make it easier for you to feel and press the controls while wearing the hearing instruments.

Components and names

This user guide describes several types of hearing instruments. Use the following pictures to identify the type of hearing instrument that you use.



- ① Hearing instrument
- ② Battery
- ③ Ear piece: Open / Closed style, L/M/S size (refer to page10)
- ④ Thin tubes
- ⑤ Storage case



Microphone



Battery compartment
(on/off switch)

Mode switch

Volume
switch

Thin tube

Ear piece

Retainer

Batteries

When the battery is low the sound becomes weaker or you will hear an alert signal. The battery type will determine how long you have to replace the battery.

Battery size and handling tips

Ask your Hearing Care Professional for recommended batteries.

Battery size: 13

- Always use the correct battery size for your hearing instruments.
- Remove the batteries if you intend not to use the hearing instruments for several days.
- Always carry spare batteries.
- Remove empty batteries immediately and follow your local recycling rules for battery disposal.

Replacing batteries

Removing the battery :

- Open the battery compartment.
- Remove the battery hand.

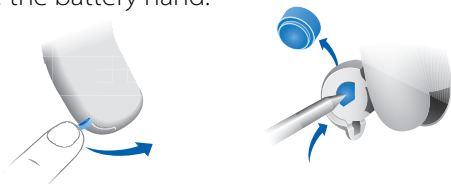

Inserting the battery :

- If the battery has a protective film, remove it only when you are ready to use the battery.



- Insert the battery with the "+" symbol facing upwards.

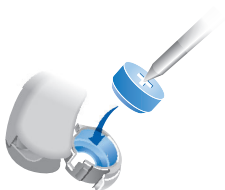

- Carefully close the battery compartment. If you feel resistance, the battery is not inserted correctly. Do not attempt to close the battery compartment by force. It can be damaged.

Daily use

Turning on and off

You have the following options to turn your hearing instruments on or off.

Via battery compartment :

- Turning off :
Open the battery compartment fully.
- Turning on :
Close the battery compartment.



Close the battery compartment.
The hearing instruments turn on after a delay of several seconds. During this time you can insert the hearing instruments into your ears without experiencing unpleasant feedback whistling.

Inserting and removing the hearing instruments

Your hearing instruments have been fine-tuned for your right and left ear. Colored markers indicate the side:

- red marker = right ear
- blue marker = left ear



■ Tubing a hearing instrument

1. Select the right or left thin tube.
red marker = right ear
blue marker = left ear

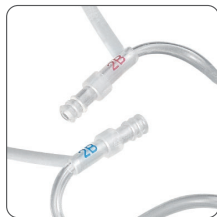

2. Attach the thin tube to the hearing instrument.



3. Use a scissor to slightly bend the retainer so that it fits into your ear to prevent the ear piece from coming out of your ear.

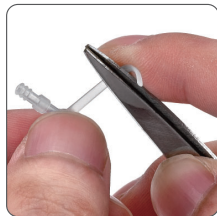

4. Put the ear piece on the thin tube. Select the size that fits most comfortably in your ear. Push the ear piece far enough into the ear canal to avoid feedback.



■ Inserting a hearing instrument

1. Place the hearing instrument behind your ear.



2. Open and close your mouth to avoid accumulation of air in the ear canal. Carefully push the ear piece into the ear canal and twist it slightly until it sits well.

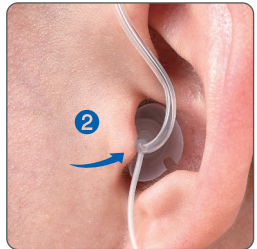

3. Place the retainer into the outer part of your ear so it follows the contour of the ear. If the retainer is visibly sticking out from your ear it has not been positioned correctly.



■ Removing a hearing instrument

- Lift the hearing instrument and slide it over the top of your ear ①.
- Hold the tube close to the ear piece and pull the ear piece out carefully ②.

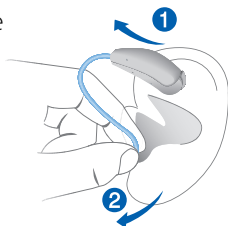

CAUTION

Risk of injury!

In very rare cases the ear piece could remain in your ear when removing the hearing instrument. If this happens, have the ear piece removed by a medical professional.

Clean and dry your hearing instruments after usage.
Read more in section "Maintenance and care".

Adjusting the volume

Your hearing instruments automatically adjust the volume to the listening situation.

- If you prefer manual volume adjustment, press the rocker switch briefly.

A signal tone indicates the volume change. Once the maximum or minimum volume level has been reached, you will hear a different signal tone. Depending on the hearing instrument type, you will also hear a signal tone for the default volume level.

Maintenance and care

To prevent damage it is important that you take care of your hearing instruments and follow a few basic rules, which will soon become a part of your daily routine.

Hearing instruments

Drying and storage :

- Dry your hearing instruments overnight.
- Ask your Hearing Care Professional for recommended drying products.
- For longer periods of non-use, store your hearing instruments with open battery compartment and batteries removed in a drying system to avoid the adverse effects of moisture.

Cleaning :

For hygiene reasons and to maintain functionality, clean your hearing instruments daily.

- Clean your hearing instruments daily with a soft, dry tissue.
- Never use running water or immerse the devices in water.
- Never apply pressure while cleaning.
- Ask your Hearing Care Professional for recommended cleaning products, special care sets, or more information on how to keep your hearing instruments in good condition.



Ear pieces and tubes



■ Open Style

Suitable for noticeable and moderate hearing loss – It has openings for sound to pass through from outside of the hearing instrument. It can sound more natural for some people but feedback may occur when the volume is turned to upper level.



■ Closed Style

Suitable for severe hearing loss – It's meant to reduce the sound from outside the hearing instrument. Feedback may not occur when the volume is turned to upper level but some people with small/narrow ear canal may feel a little bit stuffy.

There are three sizes of ear pieces Large, Medium and Small 1/each. Select the size that fits most comfortably in your ear.

Cerumen (ear wax) may accumulate on the ear pieces. This may affect sound quality. Clean the ear pieces daily.

- For hearing instruments with a standard ear piece: Exchange the ear pieces approximately every three to six months, or sooner if you notice cracks or other changes.

Ask your Hearing Care Professional to clean the tubes or to exchange tubes as needed.

- For hearing instruments with custom-made ear pieces: Ask your Hearing Care Professional to clean the tubes or to exchange the ear pieces and tubes as needed.

Cleaning ear pieces :

- Clean the ear piece upon removal with a soft and dry tissue. This prevents cerumen becoming dry and hardening.
- Never use running water or immerse the ear piece in water.

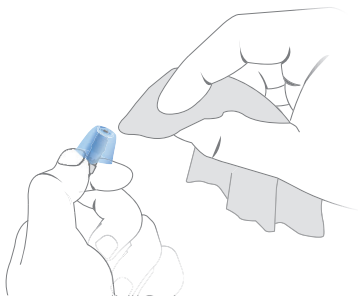

Exchanging standard ear pieces :

- Pull off the used ear piece and plug on the new ear piece.

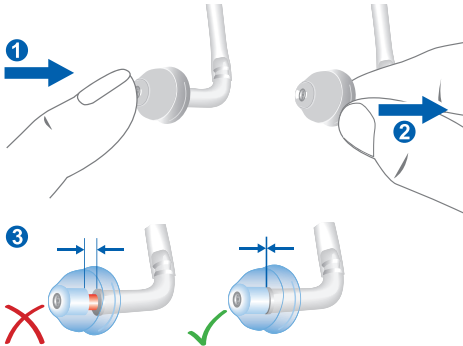

Professional maintenance

Your Hearing Care Professional can perform a thorough professional cleaning and maintenance.

Custom-made ear pieces and wax filters should be exchanged as needed by your Hearing Care Professional.

Ask your Hearing Care Professional for your individual recommendation of maintenance intervals and for support.

Safety information

For more safety information, refer to the safety manual supplied with the device.

For Hearing Care Professionals :

These hearing instruments are fitted with a smartphone app.

- Read the safety information and the instructions for fitting that are provided in the app.

For all hearing instrument types, note the following :



CAUTION

Risk of impairing the residual hearing of the client!

- In order to achieve correct fitting results, clients must be able to answer questions concerning their hearing correctly. Therefore, the described fitting procedure shall only be used for persons who are mentally capable to answer questions concerning their hearing correctly.



NOTICE

If the client is unsatisfied after trying several sound profiles then the hearing instrument type may not be suitable. Please try a different hearing instrument type.

Troubleshooting

Problems and possible solutions

Sound is weak.

- Increase the volume.
- Replace the empty battery.
- Clean or exchange the ear piece.

Hearing instrument emits whistling sounds.

- Reinsert the ear piece until it fits securely.
- Check whether tube, adapter and ear piece are connected correctly.
- Decrease the volume.
- Clean or exchange the ear piece.

Sound is distorted.

- Decrease the volume.
- Replace the empty battery.
- Clean or exchange the ear piece.

Hearing instrument emits signal tones.

- Replace the empty battery.

Hearing instrument does not work.

- Turn the hearing instrument on.
- Gently close battery compartment completely.
- Replace the empty battery.
- Make sure the battery is inserted correctly.
- Power-on delay is active. Wait several seconds and check again.



Safety manual for hearing instruments

for US and Canadian markets
Master

Safety information

This safety manual provides safety information and other important information about your hearing instruments. It covers several instrument types and optional features.

- Refer to the user guide of your hearing instruments, to check the instrument type and the activated features.

Intended use

Hearing instruments are intended to improve the hearing of hearing impaired persons. Diagnosis and prescription of a hearing instrument must be performed by hearing health specialists, e.g. acousticians, audiologists or ENT doctors.

Use the hearing instruments and accessories only as described in the respective user guides.

Explanation of symbols

Symbols used in this document



Points out a situation that could lead to serious, moderate, or minor injuries.



Indicates possible property damage.



Information and warnings for children with hearing instruments.

Symbols on the device or packaging



CE compliance label, confirms compliance with certain European Directives, refer to section "Conformance information".



EMC and radio communications compliance label Australia, refer to section "Conformance information".



Optional symbol for custom models with wireless functionality.



Indicates the legal manufacturer of the device.



Do not dispose of the device with general domestic waste. Read more in section "Disposal information".



Read and follow the instructions in the user guide.

General warnings



WARNING

Risk of impairing the residual hearing of the user.

- Use only hearing instruments that have been fitted especially for your needs.



WARNING

Risk of injury!

- Do not use obviously damaged devices and return them to point of sale.



WARNING

Note that any unauthorized changes to the product may cause damage to the product or cause injury.

- Use only approved parts and accessories.
Ask your Hearing Care Professional for support.



WARNING

Your hearing instruments may reduce certain background sounds, potentially also traffic or warning signals.



WARNING

Risk of explosion!

- Do not use your hearing instruments in explosive atmospheres (e. g. in mining areas).



WARNING

Choking hazard!

Your hearing instruments contain small parts which can be swallowed.

- Keep hearing instruments, batteries and accessories out of reach of children and mentally disabled persons.
- If parts have been swallowed consult a physician or hospital immediately.

If you have hearing instruments that are intended for the fitting of children under the age of 3 years or persons with a developmental age of under 3 years, refer also to section "For children under the age of 3 years".



NOTICE

- Protect your hearing instruments from high humidity. Do not wear them in the shower or when you apply make-up, perfume, aftershave, hairspray or suntan lotion.



NOTICE

- Protect your hearing instruments from extreme heat. Do not expose them to direct sunlight.



NOTICE

- Do not dry your hearing instruments in the microwave oven.



NOTICE

Different types of strong radiation, e. g. during X-ray or MRI head examinations, may damage hearing instruments.

- Do not wear the hearing instruments during these or similar procedures.

Weaker radiation, e. g. from radio equipment or airport security, does not damage the hearing instruments.



NOTICE

Your devices comply with international standards. However, it cannot be guaranteed that all products on the market work interference-free, for example some induction cookers may cause audible interference.

Contraindications



WARNING

Consult a Hearing Care Professional if you experience any unusual side effects like skin irritation, excessive accumulation of ear wax, dizziness, change in your hearing, or if you think there may be a foreign object in your ear canal.



WARNING

A Hearing Care Professional should advise a prospective hearing instrument user to consult a licensed physician before using the hearing instrument if the Hearing Care Professional determines that the prospective user has any of the following conditions:

- Visible congenital or traumatic deformity of the ear.
- History of active drainage from the ear within the previous 90 days.
- History of sudden or rapidly progressive hearing loss within the previous 90 days.
- Acute or chronic dizziness.
- Unilateral hearing loss of sudden or recent onset within the previous 90 days.
- Audiometric air-bone gap equal to or greater than 15 dB at 500 Hz, 1,000 Hz, and 2,000 Hz.
- Visible evidence of significant cerumen accumulation or a foreign body in the ear canal.
- Pain or discomfort in the ear.

For hearing instruments with wireless functionality



In some countries restrictions for the usage of wireless equipment exist.

- Refer to local authorities for further information.
-



WARNING

Risk of affecting electronic equipment!

- In areas where the use of electronics or wireless devices are restricted, verify if your device has to be turned off.
-



NOTICE

Your hearing instruments are designed to comply with international standards on electromagnetic compatibility but interference with nearby electronic devices could occur. In this case, move away from the source of interference.

For hearing instruments with a tinnitus feature

Your hearing instrument may be equipped with a tinnitus feature (e. g. with a tinnitus therapy signal, a tinnitus noiser, or another special function). The use of the tinnitus feature should be only on the advice and in consultation with your Hearing Care Professional.



WARNING

Risk of further impairment to the user's hearing health.

The volume of the tinnitus feature can be set to a level which could lead to permanent hearing damage when used for a prolonged period of time.

- The tinnitus feature should never be used at uncomfortable levels.

For hearing instruments with AutoPhone magnet



WARNING

Risk of affecting life support systems!

- Use a magnet only when it is a safe distance away from life support systems, such as pacemakers or magnetic valves. For example, the safe distance between pacemaker and magnet should be at least 10 cm (4 inches).



NOTICE

Magnets can disturb electrical devices and delete stored data.

- Keep magnets away from computers, monitors, television sets, storage media and other electronic equipment/devices.



NOTICE

In close proximity, AutoPhone magnets can damage receiver units of RIC hearing instruments.

- Keep a minimum distance of 2 cm between the RIC receiver and any magnet, including the AutoPhone magnet.
For example, do not store your RIC hearing instruments and a smartphone with attached AutoPhone magnet together in a small pocket or box.

For hearing instruments with a magnet in the battery compartment



WARNING

Risk of interference with active and non-active implants!

If you wear an active or a non-active implant, e.g. a brain implant:

- Prior to use, have the electromagnetic compatibility verified.
Consult the physician that implanted the device before using your hearing instruments.
- Keep a safe distance of about 1.6 inches (4 cm) between the implant and hearing instruments.

For certain instrument types

BTE models

Instruments that are worn behind the ear and that have a tube.



CAUTION

Risk of injury!

- Always wear the tube with an ear piece.
- Make sure that the ear piece is completely attached.

RIC models

The receiver is placed within the ear canal and connected to the instrument via a receiver cable.



Risk of injury!

- Always wear the receiver cable with an ear piece.
- Make sure that the ear piece is completely attached.



NOTICE

X Do not pull the receiver connection as this could damage your hearing instruments.



Other models

For all other models, no model-specific safety information applies.

For children under the age of 3 years

There are special hearing instruments for the fitting of children under the age of 3 years or persons with a developmental age of under 3 years. Ask your Hearing Care Professional for further information.



WARNING



Choking hazard!

Your hearing instruments contain small parts which can be swallowed.

- Ensure adequate supervision if infants, small children or mentally disabled persons need to wear hearing instruments.
- Check the completeness of the hearing instruments regularly.
- Ensure that your child or the mentally disabled person does not detach the hearing instrument from the earmold.
- Consult your Hearing Care Professional if the housing is deformed.
- Keep the battery compartment locked. Verify the proper function of the locking mechanism.
- Keep batteries and accessories out of children's or mentally disabled person's reach.
- If swallowed consult a physician or a hospital immediately.

For certain battery types

For hearing instruments with built-in power cells (lithium-ion rechargeable batteries)

Read the safety information on power cells in the hearing instrument's user guide.

For hearing instruments with replaceable batteries



NOTICE

Only use zinc-air batteries or nickel-metal hydride (NiMH) rechargeable batteries.

Do not use e.g. silver-zinc or lithium-ion rechargeable batteries.



NOTICE

Leaking batteries damage the hearing instruments.

- Turn the hearing instruments off when not in use to preserve the battery.
- Remove batteries when the instruments are not in use for a prolonged period of time.

When using remote control apps

When using an app for controlling hearing instruments:



WARNING

Risk of hearing damage!

The device with the app for controlling hearing instruments generates short control signals which may be audible. If the device running the app has a very high audio output there is the risk of hearing damage.

While using the app:

- Do not hold the loudspeaker of the device to your ears or the ears of others.
- Do not use the device with headphones, headsets or other audio playback devices.

For Hearing Care Professionals



WARNING

For hearing instruments with an output sound pressure level of 132 dB SPL or more:

Risk of impairing the residual hearing of the user.

- Take special care when fitting this instrument.
While using the app:

Tinnitus feature

The target population is primarily the adult population over 21 years of age. The patient may have some control of the level or volume of the signal and the patient should discuss this adjustment as well as his or her comfort level and sound of the signal with their Hearing Care Professional.



WARNING

Risk of further impairment to the user's hearing health.

The volume of the tinnitus feature can be set to a level which could lead to permanent hearing damage when used for a prolonged period of time.

- Should the tinnitus feature be set to such a level in the hearing instrument, advise the user of the maximum amount of time per day he or she should use the tinnitus feature.
For example, occupational safety guidelines restrict continuous noise exposure of 80 dBA SPL to 8 hours per day.
- The tinnitus feature should never be used at uncomfortable levels.

Important information

Operating, transport and storage conditions

For hearing instruments with built-in power cells
(lithium-ion rechargeable batteries)

Read the operating, transport and storage conditions in
the hearing instrument's user guide.

For hearing instruments with replaceable batteries

Operating conditions

Temperature 0 to 50 °C (32 to 122 °F)

Relative humidity 5 to 93 %

During extended periods of transport and storage, please
observe the following conditions:

| | Storage | Transport |
|-------------------|-------------------------------|--------------------------------|
| Temperature | 10 to 40 °C (50 to 104 °F) | -20 to 60 °C (-4 to 140 °F) |
| Relative humidity | 10 to 80 % | 5 to 90 % |

For other parts, such as batteries, other conditions may
apply.

