

Mimitakara®

RECHARGEABLE BTE HEARING AID 6EKA User Guide

ACCESSORIES

- ❶ Anti-dropping ringx1
- ❷ No.2 Eartube+Earbud (M) x2
- ❸ No.3 Eartube x2
- ❹ Earbud(L/M/S/) x2
- ❺ Hearing Aid (Left Ear/Right Ear) x1
- ❻ USB Type-C Charging Cable x1
- ❼ Charging Stand x1



CONTENTS

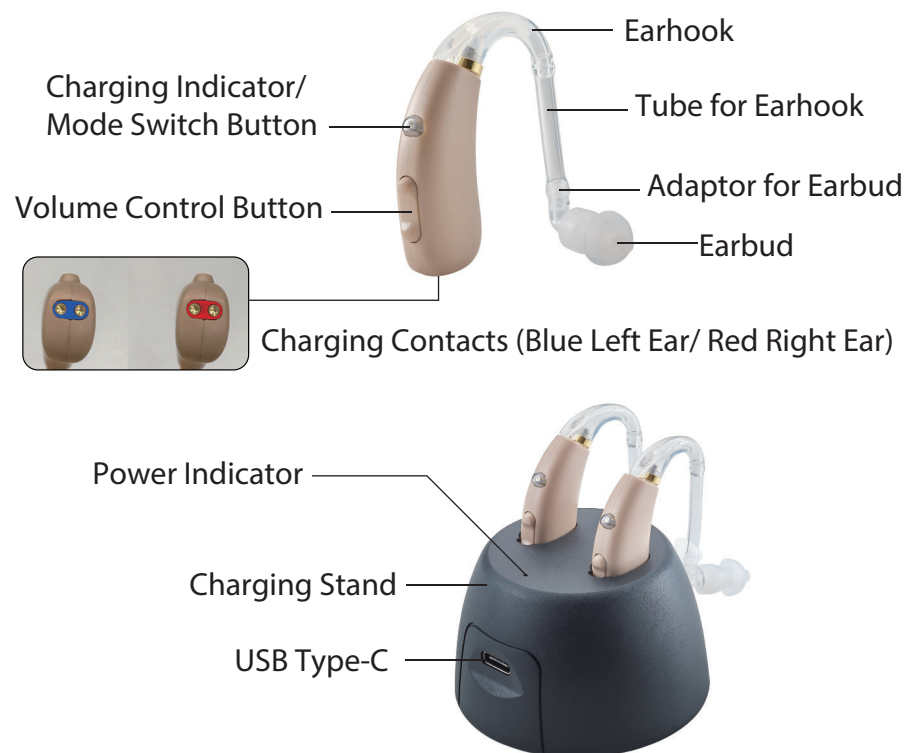

SET UP

Please install the hearing aid with the cut eartube (please refer to the eartube cut method). (No.2 eartube is standard size. No.3 eartube is larger size, they can be switched depending on the needs)

※ As picture shown, please insert the earbud to the adaptor all the way in case of feedback sound from the air flows in.

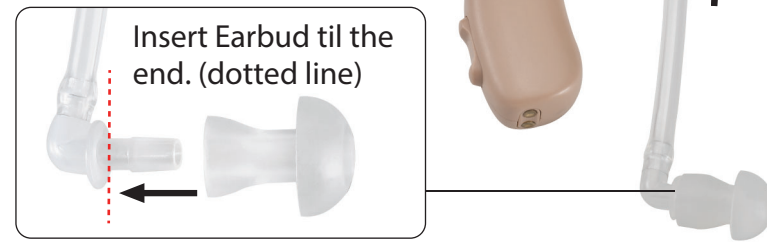

HOW TO CUT EARTUBE?

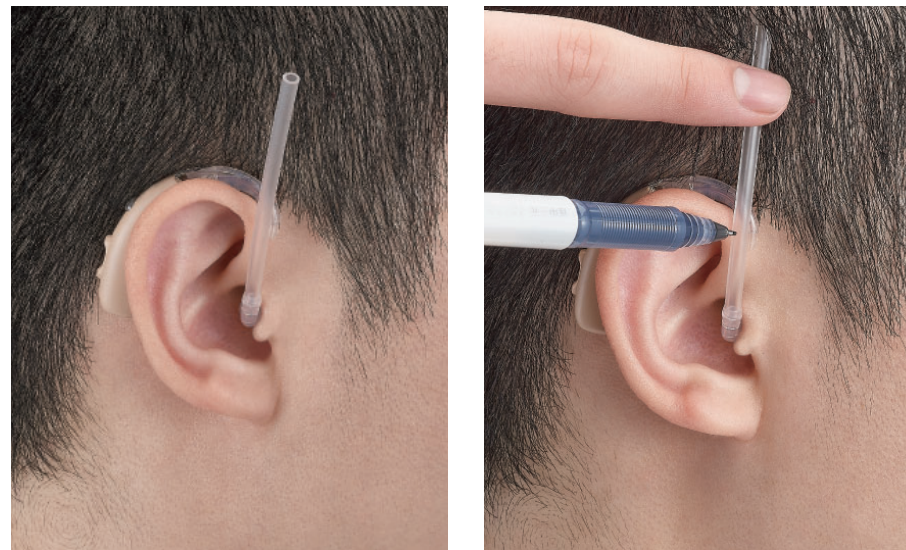

1. Please put the hearing aid behind the ear, and put the eartube with earbud in the ear.
2. Mark on the eartube where earhook and eartube is connected.



3. Take off the eartube, and cut off the marking place.
4. Put the eartube on the hearing aid to complete the wearing.

CHARGING STATUS

※ Please charge the hearing aid for 2 hours at least, so it can continuous use for 15 hours per charge.

Please charge the hearing aid immediately when the volume is lower or not properly works.

1. Please connect the USB Type-C with USB Adaptor, and put the adaptor into AC power; the charging indicator will turn on constantly.

2. Put the hearing aid on the charging stand as shown on the right, the indicator is steadily on; when the charging is full the indicator is off.



ON/OFF

ON: After removing the hearing aid from the charging cradle, press and hold the hearing aid mode switch button; the hearing aid indicator light will blink three times to be ready for use.

OFF: When the hearing aid is on, press and hold the hearing aid mode switch button; the hearing aid indicator will turn off after "blinking twice" or the hearing aid will turn off automatically when it is put back into the charging stand.

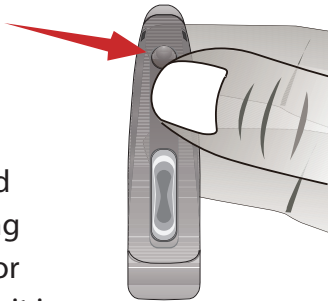

VOLUME CONTROL AND MODE SWITCH

Volume control

- Volume up: press the up button
- Volume down: press the down button

Mode switch

Provide with 4 modes, press the mode button to switch, the beep sound indicates the modes.

- Standard mode: 1 beep sound
- Noise cancelling mode: 2 beep sound
- Meeting mode: 3 beep sound
- Outdoor mode: 4 beep sound

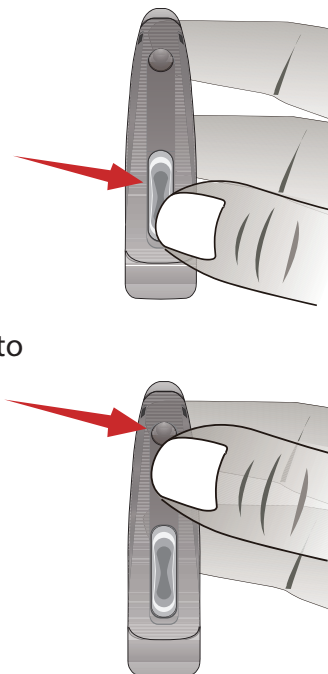

HOW TO WEAR HEARING AID

1. When wearing, turn off the hearing aid or lower the volume.
2. Pinch the earbud with your index finger and thumb and carefully insert the earbud into the ear canal. Gently push the back of the ear to help insert the earbud into the ear canal.

▶ Put the earbud tightly into the ear canal

⚠ Notice: The hearing aid should be turned off and volume knob should be in the minimum position, otherwise the feedback sound may occur when the moment of earbud inserting in the ear canal.

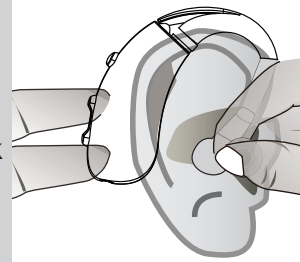

3. If you feel a whistling sound, please check whether the earbuds are tightly plugged. If you feel that the earbud cannot be tightly plugged, please replace the earbud with other sizes.

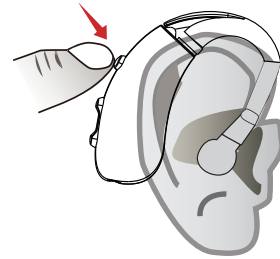
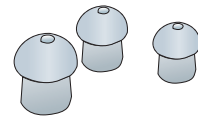

4. Press and hold the mode switch button, the indicator light will flash three times, the hearing aid can be turned on and start using.

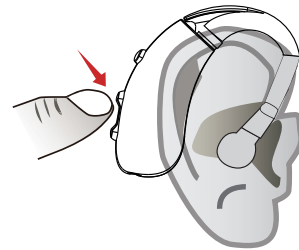

5. Adjust the volume button and adjust it until the sound is clear.

REMOVING A HEARING AID

1. Press and hold the mode switch button, the hearing aid indicator will blink twice and a "beep" sound will be emitted, the hearing aid will be turned off.

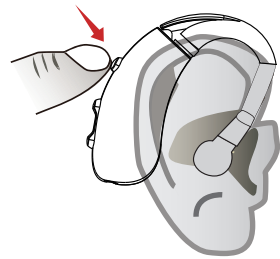

2. ① Twist the earbud with your index finger and thumb and carefully pull it out of the ear canal.

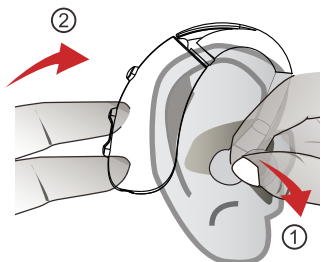

- ② Gently push on the back of the ear to help pull the earbud out of the ear canal.

MAINTENANCE

1. Clean your earwax with a cotton swab before wearing the hearing aid. Earwax that clogs the earbud holes will affect the quality of the sound you receive.
2. Earwax is most likely to block the earbud holes. Please use the attached cleaning brush to clean the earwax from the earbud holes frequently.

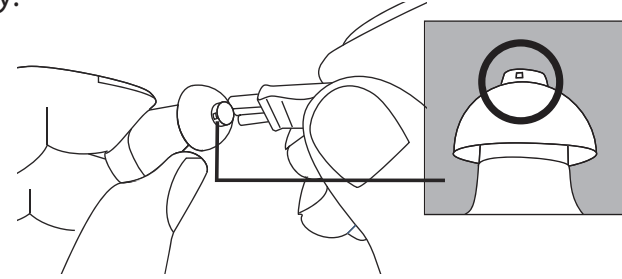

3. Do not put it in a place with high temperature and high humidity. In addition, do not put it in an environment full of dust and harmful gases.
4. Please turn off the hearing aid when not in use

Q & A

Problem	Potential Cause	Solution
Sound is weak	Low battery power	Charge immediately
	Speaker and earbud is clogged	Clear clogs or replace earbud
	The degree of hearing loss is changed	Adjust the volume or ask a doctor for assistance
	Dirt accumulation	Clean the hearing device
Functionality problems	Low battery power	Charge immediately
	Speaker and earbud is clogged	Clear clogs or replace earbud
Sound is not clear, distortion, no sound	Low battery power	Charge immediately
	Speaker and earbud is clogged	Clear clogs or replace earbud
	Hearing device malfunction	Consult the hearing service center

DAILY TRAINING

Week 1 : Wear a hearing device at home and get used to the sound.
Suggested time: about 2 hours per day

Week 2 : Talk to people in a quiet environment.
Suggested time: about 3 hours per day

Week 3 : Practice hearing the TV / Listening to music / Talking over phone.
Suggested time: about 4 hours per day

Week 4 : Try to talk with many people at the same time, and practice in an outdoor environment after getting used to it.
Suggested time: about 5 hours or more per day

! Notice

- Please follow this instruction manual to operate and store this product.
- Do not allow infants or involuntary people to use this product.
- Do not use this product while you are sleeping.
- Do not engage in strenuous exercise while using this product.
- Do not use this product together with your cell phone, otherwise it will affect the effect of the hearing aid.
- Keep the product dry, do not use it when bathing or washing your hair; avoid touching water when washing your face or using the hair wax.
- When disposing of worn out hearing aids and batteries, please follow the local metal waste disposal regulations.
- Do not disassemble the hearing aid.

SPECIFICATIONS AND FEATURES

Product name: Mimitakara Rechargeable BTE Hearing Aid

Model: 6EKA

Suitable for: people with moderate to severe hearing loss

Power supply: USB Type-C

Continuous use: Up to 15 hours per charge

Operating temperature and humidity : +10°C~+40°C , 30%~85%RH

Storage temperature and humidity : -10°C~+60°C , 30%~85%RH

Size: [Hearing aid] 41x31x9 mm

Weight: [Hearing aid] 3.4 g

Material: [Hearing aid], [Charging stand] ABS, [Earbuds] silicone

Place of origin: Taiwan